

DIN 6885 A

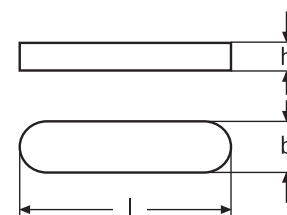

Wpust pryzmatyczny
1.4571

h	4,0	5,0	6,0	7,0	8,0	8,0	9,0
---	-----	-----	-----	-----	-----	-----	-----

b	4	5	6	8	10	12	14
l 8	0,101						
10	0,115	0,195	0,278				
12	0,140	0,214	0,336				
14		0,254	0,378				
16	0,190	0,293	0,416				
18	0,215						
20	0,240	0,371	0,529	0,805		2,150	
22			0,586	0,892			
25		0,470	0,671	1,030			2,980
28				1,160			
30		0,398	0,799	1,425	2,150	2,265	
32			0,868	1,340	1,880	2,410	
36			0,984	1,510	2,130	2,520	3,270
40			1,090	1,690	2,380	2,820	3,660
45			1,230	1,910	2,700	3,200	4,150
50			1,370	2,130	3,010	3,580	4,650
56							5,240
60			1,640	2,770	3,634	3,021	4,890
63							6,620
70				3,010	4,270	5,090	4,650
80				3,450	4,890	5,840	7,610
90				3,990	5,520	6,590	8,600
100				4,340	6,150	7,350	9,590
110							10,600
	100	100	100	100	100	100	100

Waga 100 sztuk /kg