

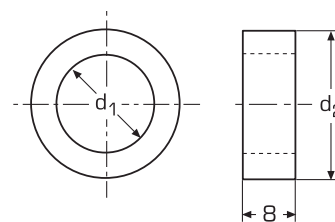

DIN 7989



Podkładka pod śruby do
konstrukcji stalowych
A2 / A4

d1	dla gwintu	waga 100 szt. (kg)	d2	
A 11	M 10	1,570	20	100
14	M 12	1,880	24	100
18	M 16	2,830	30	100
22	M 20	4,360	37	100
24	M 22	4,620	39	50
26	M 24	6,150	44	50
30	M 27	7,900	50	25
33	M 30	10,100	56	25
36	M 33	11,400	60	25
39	M 36	14,000	66	25