

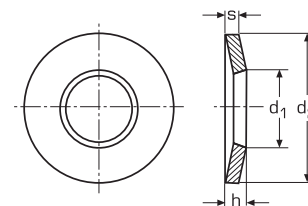

DIN 6796



Podkładka talerzowa
A2 / A4

| dla gwintu | waga 100 szt. (kg) | d1 | d2 | s | h max | h min |  |
|-------------|-----------------------|------|------|-----|-------|-------|---|
| M 3 | 0,014 | 3,2 | 7,0 | 0,6 | 0,85 | 0,72 | 200 |
| M 4 | 0,038 | 4,3 | 9,0 | 1,0 | 1,3 | 1,12 | 200 |
| M 5 | 0,069 | 5,3 | 11,0 | 1,2 | 1,55 | 1,35 | 200 |
| M 6 | 0,143 | 6,4 | 14,0 | 1,5 | 2,0 | 1,7 | 200 |
| M 8 | 0,313 | 8,4 | 18,0 | 2,0 | 2,6 | 2,24 | 200 |
| M 10 | 0,645 | 10,5 | 23,0 | 2,5 | 3,2 | 2,8 | 200 |
| M 12 | 1,240 | 13,0 | 29,0 | 3,0 | 3,95 | 3,43 | 100 |
| M 14 | 2,160 | 15,0 | 35,0 | 3,5 | 4,65 | 4,04 | 100 |
| M 16 | 3,040 | 17,0 | 39,0 | 4,0 | 5,25 | 4,58 | 100 |
| M 18 | 3,890 | 19,0 | 42,0 | 4,5 | 5,8 | 5,08 | 100 |
| M 20 | 4,880 | 21,0 | 45,0 | 5,0 | 6,4 | 5,6 | 100 |
| M 22 | 6,350 | 23,0 | 49,0 | 5,5 | 7,05 | 6,15 | 100 |
| M 24 | 9,290 | 25,0 | 56,0 | 6,0 | 7,75 | 6,77 | 100 |