

DIN 435

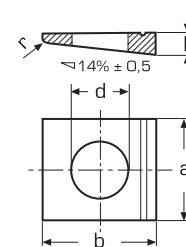

Podkładka klinowa do dwuteowników,
nachylenie 14%
A2 / A4

d	waga 100 szt. (kg)	a	b	h	r	
9,0	1,010	22	22	4,6	1,2	50
11,0	0,940	22	22	4,6	1,2	50
13,5	2,010	26	30	6,2	1,6	25
17,5	3,560	32	36	7,5	2	25
22,0	6,700	40	44	9,2	2,4	25
24,0	9,000	44	50	10	2,4	10
26,0	14,300	56	56	10,8	2,4	10

DIN 436

PN 82010

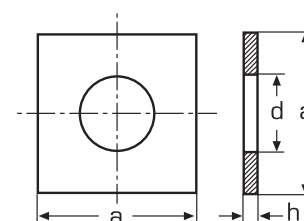

Podkładka kwadratowa
A2 / A4

wymiar	waga 100 szt. (kg)	d	a	h	
M 10	1,880	11,0	30,0	3,0	100
M 12	4,540	13,5	40,0	4,0	100
M 16	8,820	17,5	50,0	5,0	100
M 20	12,600	22,0	60,0	5,0	50
M 22	19,500	24,0	70,0	6,0	50
M 24	27,500	26,0	80,0	6,0	50