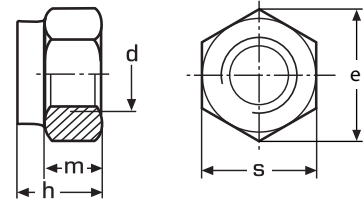

DIN 985

PN 82175

Nakrętka samozabezpieczająca
 z wkładem poliamidowym

A2 / A4

d	waga 100 szt. (kg)	s	e	m	h	
M 2,5	0,030	5,0	5,5	2,3	3,5	1000
M 3	0,050	5,5	6,01	2,4	4,0	1000
M 4	0,100	7,0	7,66	2,9	5,0	1000
M 5	0,140	8,0	8,79	3,2	5,0	1000
M 6	0,240	10,0	11,05	4,0	6,0	500
M 8	0,510	13,0	14,38	5,5	8,0	200
M 8 x 1	0,510	13,0	14,38	5,5	8,0	200
M 10	1,060	17,0	18,9	6,5	10,0	100
M 10 x 1	1,060	17,0	18,9	6,5	10,0	100
M 12	1,720	19,0	21,1	8,0	12,0	100
M 12 x 1,5	1,720	19,0	21,1	8,0	12,0	100
M 14	2,600	22,0	24,49	9,5	14,0	100
M 16	3,400	24,0	26,75	10,5	16,0	50
M 16 x 1,5	3,400	24,0	26,75	10,5	16,0	50
M 18	4,500	27,0	29,56	13,0	18,5	50
M 20	6,500	30,0	32,95	14,0	20,0	50
M 20 x 1,5	6,500	30,0	32,95	14,0	20,0	50
M 22	7,500	32,0	35,05	15,0	22,0	50
M 24	10,000	36,0	39,55	15,0	24,0	25
M 24 x 1,5	10,000	36,0	39,55	15,0	24,0	25
M 27	16,200	41,0	45,02	17,0	27,0	25
M 30	21,200	46,0	50,85	19,0	30,0	25