

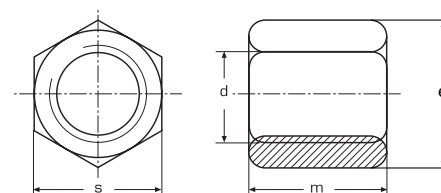

DIN 6334



Nakrętka sześciokątna
wysoka 3d
A2 /A4

d	waga 100 szt. (kg)	s	e	m	
M 5	0,850	8	9,0	15	100
M 6	1,010	10	11,05	18	100
M 8	1,841	13	15,0	24	100
M 10	2,550	17	19,6	30	100
M 12	1,730	19	21,9	36	50
M 16	2,530	24	27,7	48	50
M 20	8,500	30	34,6	60	25
M 24	33,000	36	41,6	72	25
M 30	66,900	46	53,1	90	25