

# DIN 910

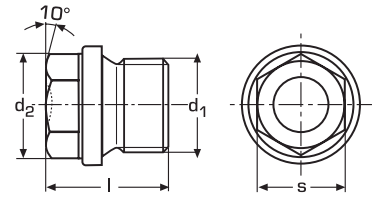
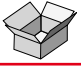

Korek walcowy z łbem sześciokątnym  
**A2 / A4**

d1	waga 100 szt. (kg)	d2	s	t	i	
<b>G 1/8A</b>	1,200	44	19	10,5	11	100
<b>G 1/4A</b>	2,380	18	6	7	15	100
<b>G 3/8A</b>	3,810	22	8	7,5	15	100
<b>G 1/2A</b>	6,660	26	10	7,5	18	50
<b>G 3/4A</b>	12,700	32	12	9	20	25
<b>G 1A</b>	19,500	39	17	9	21	25
<b>G 1 1/4A</b>	30,000	49	22	10,5	21	10
<b>G 1 1/2A</b>	37,500	55	24	10,5	21	10
<b>G 2 A</b>	69,500	68	32	14	25	10
<b>M 10x1</b>	1,200	14	5	5	11	100
<b>M 12x1,5</b>	2,030	17	5	5	15	100
<b>M 14x1,5</b>	2,500	19	6	7	15	100
<b>M 16x1,5</b>	3,520	21	8	7,5	15	50
<b>M 18x1,5</b>	4,860	23	8	7,5	16	50
<b>M 20x1,5</b>	6,450	25	10	7,5	18	50
<b>M 22x1,5</b>	7,340	29	10	7,5	18	25
<b>M 24x1,5</b>	9,350	31	12	7,5	18	25
<b>M 27x1,5</b>	12,000	32	12	9	20	25
<b>M 27x2</b>	12,700	36	12	9	20	25
<b>M 30x1,5</b>	14,800	36	17	9	20	25
<b>M 30x2</b>	14,800	12	17	9	20	25